

Multipurpose Tent (MSF Type)

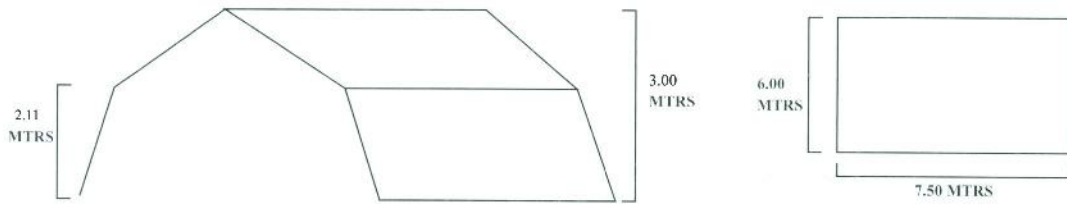

Basic Specifications

Length	: 7.50 Meters	Frame	: Made Of Aluminium Pipe
Width	: 6.00 Meters	Ventilators	: Two
Central Height	: 3.00 Meters	Pegs	: Ten Made Of Steel
Wall Height	: 2.11 Meters	Pins	: Twenty Six Made Of Steel
Door Height	: 1.90 X 2, 2.10 X 2	Hammer	: One Made Of Iron
Door Width	: 1.40x2, 3.50x2	Ground Sheet	: Made Of Approx 540 G/M2 Pvc
Doors	: Four	Dimension Unit	: 230*95*35 Cm
Windows	: Four	Packing Unit	: 2 Pvc Bundles Joined As A Sandwich Pack.



Outer Tent Roof :

Made Of Single Layer Of Poly / Cotton Water And Rotproof, Uv Treated Canvas Quality Approx.440G/M2.

Outer Tent Side Wall :

Made Of Single Layer Of Poly/Cotton Water And Rotproof, Uv Treated Canvas Quality Approx 320 G/M2.

Inner Tent :

Made Of Single Layer Of Poly/Cotton Water And Rotproof, Uv Treated Canvas Quality Approx 120 G/M2.

Packed Volume :

0.74 M3 Packed Qty . Per 20' Container: 36 Packed Qty Per 40' Container: 72

Optional: Inner Tent Made Of Poly/Cotton Canvas Approx.130 G/M2 Partition Walls Made Of Pvc Approx. 300 G/M2 Shed Net Of Approx.140 G/M2 Uv Treated

